

INDUSTRIAL PLUGS AND SOCKETS

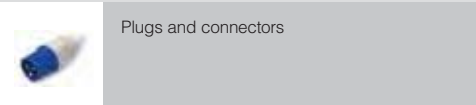

VERSIONS



Plugs and connectors

REFERENCE STANDARDS

**EN 60309-1**  
Plugs, socket-outlets and couplers for industrial purposes.  
*Part 1: general requirements.*

**EN 60309-2**  
Plugs, socket-outlets and couplers for industrial purposes.  
*Part 2: dimensional interchangeability requirements for pin and contact-tube accessories.*

QUALITY MARKS



TECHNICAL CHARACTERISTICS

Rated current:	<b>16A-32A</b>
Rated voltage:	<b>100÷415V~</b>
Frequency:	<b>c.c. - 50÷500Hz</b>
Insulating voltage:	<b>500/690V~</b>
Protection degree:	<b>IP44</b>
Operating temperature according to the reference standard:	<b>-25°C +40°C</b>
Max. operating temperature:	<b>60°C</b>
Glow Wire test:	<b>650°C/850°C</b>
Material:	<b>Engineering plastic</b>
IK degree at 20°C:	<b>IK08</b>
Cable inlets:	<b>Cable sleeve</b>

WIRING AND INSTALLATION

Wiring capacity of the terminals  
Cross-section of connectable conductors (mm²)

Rated voltage	Rated current (A)	Plugs, connectors and appliance inlets		Socket outlets	
		Min	Max	Min	Max
>50V	16A	1	2,5	1,5	4
	32A	2,5	6	2,5	10
	63A	6	16	6	25
	125A	16	50	25	70

Max. cable size accepted by the cable clamp:

Rated current (A)	Outside Ø mm	
	Min	Max
16A	8	15
32A	11,5	21
63A	17	31
125A	26	48

BEHAVIOUR WITH CHEMICAL AND ATMOSPHERIC AGENTS

Saline solution	Acids		Bases		Solvents				Mineral oil	UV rays
	Concentrated	Diluted	Concentrated	Diluted	Hexane	Benzol	Acetone	Alcohol		
Resistant	Limited Resistance	Resistant	Resistant	Resistant	Limited Resistance	Limited Resistance	Resistant	Resistant	Resistant	Resistant

DIMENSIONS

MOBILE PLUGS - IP44

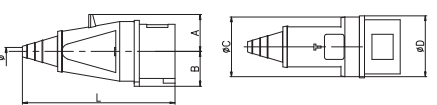

		L	B	Ø
16A	2P+E	135	58	7
	3P+E	142	67	7
	3P+N+E	159	76	9
32A	2P+E	174	79	9
	3P+E	174	79	9
	3P+N+E	180	88	10

MOBILE PLUGS - IP44

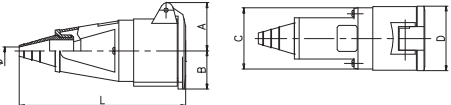

		A	B	C	D	L	Ø
16A	2P+E	38	29	50	50	146	7
	3P+E	41	32	55	57	155	7
	3P+N+E	49	39	62	65	168	9
32A	2P+E	47	39	56	65	182	9
	3P+E	47	39	56	65	182	9
	3P+N+E	51	42	69	71	193	13

APPLICATION EXAMPLES



INDUSTRIAL PLUGS AND SOCKETS



VERSIONS

	Plugs and connectors
	Panel mounting socket outlets
	Surface mounting socket outlets

REFERENCE STANDARDS

<p><b>EN 60309-1</b> Plugs, socket-outlets and couplers for industrial purposes. <i>Part 1: general requirements.</i></p>
<p><b>EN 60309-2</b> Plugs, socket-outlets and couplers for industrial purposes. <i>Part 2: dimensional interchangeability requirements for pin and contact-tube accessories.</i></p>

QUALITY MARKS



TECHNICAL CHARACTERISTICS

Rated current:	16A-32A
Rated voltage:	<50V~
Frequency:	c.c. - 50÷500Hz
Insulating voltage:	500/690V~
Protection degree:	IP44-IP66/IP67
Operating temperature according to the reference standard:	-25°C +40°C
Max. operating temperature:	60°C
Glow Wire test:	650°C/850°C
Material:	Engineering plastic
IK degree at 20°C:	IK08 - IK10
Cable inlets:	Cable sleeve IP44 Cable gland IP66/IP67

BEHAVIOUR WITH CHEMICAL AND ATMOSPHERIC AGENTS

Saline solution	Acids		Bases		Solvents				Mineral oil	UV rays
	Concentrated	Diluted	Concentrated	Diluted	Hexane	Benzol	Acetone	Alcohol		
Resistant	Limited Resistance	Resistant	Limited Resistance	Resistant	Resistant	Limited Resistance	Not Resistant	Resistant	Resistant	Resistant

WIRING AND INSTALLATION

Wiring capacity of the terminals  
Cross-section of connectable conductors (mm²)

Rated voltage	Rated current (A)	Plugs, connectors and appliance inlets		Socket outlets	
		Min	Max	Min	Max
<50V	16A	4	10	4	10
	32A	4	10	4	10

Max. cable size accepted by the cable clamp:

Rated current (A)	Outside Ø mm	
	Min	Max
16A	8	15
32A	11,5	21

FIXING

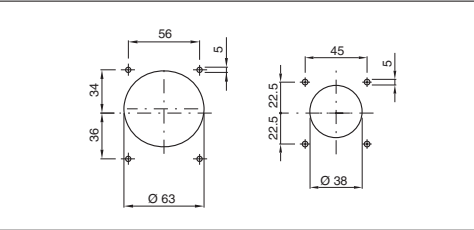

(Dimensions in mm)

SCAME sockets for voltage < 50V can be surface mounted or panel mounted on panel boards, or where the surface is set up with the following perforation.

APPLICATION EXAMPLES



## MOBILE PLUGS - IP44

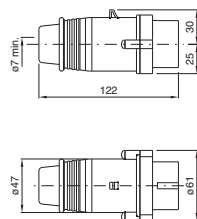

## MOBILE PLUGS - IP66/IP67

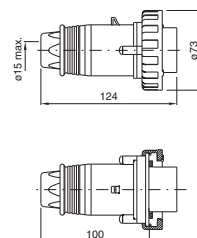

### PANEL MOUNTING SOCKET OUTLETS - ANGLED STANDARD FLANGE - IP44

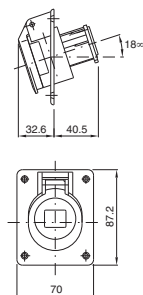

### PANEL MOUNTING SOCKET OUTLETS - ANGLED STANDARD FLANGE - IP66/IP67

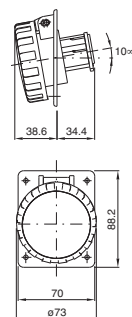

## SURFACE MOUNTING SOCKET OUTLETS ANGLED BOX - IP44

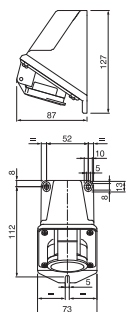

## SURFACE MOUNTING SOCKET OUTLETS ANGLED BOX - IP66/IP67

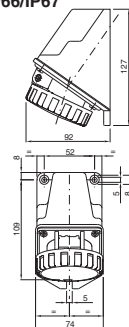

(Dimensions in mm)

## CONNECTORS - IP44

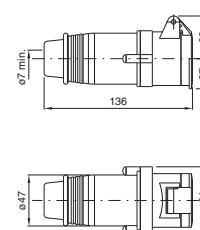

## CONNECTORS - IP66/IP67

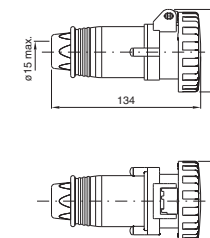

### PANEL MOUNTING SOCKET OUTLETS - STRAIGHT REDUCED FLANGE - IP44

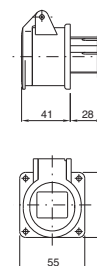

### PANEL MOUNTING SOCKET OUTLETS - STRAIGHT REDUCED FLANGE - IP66/IP67

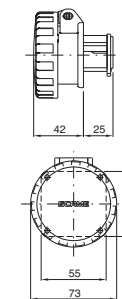

## SURFACE MOUNTING SOCKET OUTLETS STRAIGHT BOX - IP44

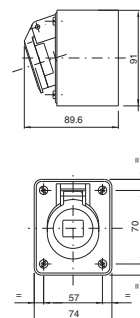

**SURFACE MOUNTING SOCKET OUTLETS**  
**STRAIGHT BOX - IP66/IP67**

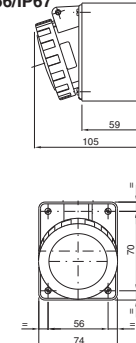

(Dimensions in mm)